

## **2018 Whitko Marching Pride - Saturday September 8th @ Bluffton**

### **Friday**

3:15 PM Call Time; Change into full uniform  
4:00 PM Group/Individual Pictures  
6:00 PM Move equipment out for game; warmup  
6:30 PM Move out to stands for game  
Dismissed @ end of game (**weather may play a role in our plans, please be attentive and flexible!**)

### **Saturday**

10:00 AM Rehearsal  
12:45 PM Eat/Pack/Load  
1:45 PM Depart for Bluffton HS  
2:45 PM Arrive at Bluffton HS/Change  
3:50 PM Circle  
4:27 PM Physical Warmup  
4:56 PM Musical Warmup  
5:36 PM Performance  
6:15 PM Awards (in uniform, awards are immediately after our performance)  
\*7:30 PM Depart Bluffton HS  
\*8:00 PM Dinner stop in Bluffton (45 minutes)  
\*10:00 PM Return to Whitko HS/Unload/Clean/Dismissed

\*All times with an asterisk are approximate. These are best guesses based on information provided to the director.

### **Notes for students**

- Dress will be in full uniform. Wear your black socks and marching shoes on the bus.
- You will need to bring a lunch and snacks for the bus. We will plan on stopping for a quick dinner on the way home. **No one is permitted to leave for lunch**
- After awards please take directions from our parent volunteers as I will be in critique with the judges. They will bring you back to the buses to change, pack, and get ready for departure.
- Please make sure your ride is at Whitko by the time we return. Return times are always best guesses so have some way of contacting your ride when we finish dinner.

### **Notes for parents/spectators**

- Tickets are \$7 for adults and \$5 for students/senior citizens.
- Be sure to sign up for the Remind service to receive a live ETA on our return time!
- Make sure you like our Facebook page. Results and other important information will be posted there.

Well, here we are. This is the moment I have been waiting for ever since November 4th, 2017...our first competition. The whole state knows what you did last year, and they are going to expect you to go out and show them that we didn't just catch lightning in a bottle, but that we are a force to be reckoned with! You have put in so much hard work and effort to learn this show, I am so excited to see you take it out and show everyone what you can do. **Bands are not proud because they perform well, they perform well because they are proud.** Let's go out and show them what PRIDE is all about!!

Mr. VanPatten

2018

## SPECTATOR PARKING

Again this year our visual warm-up areas will be on the parking lot instead of grass. Because of this we will lose some of the parking in our middle school lot. We do however have a large lot available at our elementary school. We will continue to offer parking in our middle school parking lot but we encourage you to inform your parents of the elementary parking lot option.

**Spectator parking at middle school** – take highway 1 south to 116 East (Kroger store at corner). Continue east on 116 through 4 way stop and parking will be on the left.

Entrance to stadium through main gate (south end of stadium)

**Spectator parking at elementary school** – take highway 1 south to Spring Street (CVS store at corner). Continue east on Spring Street through 4 way stop and parking will be on your right.

Entrance to stadium through southeast gate.

Thank you for your help in educating your fans as we continue our efforts to make things better each year.







# Bluffton High School

Band Entrance

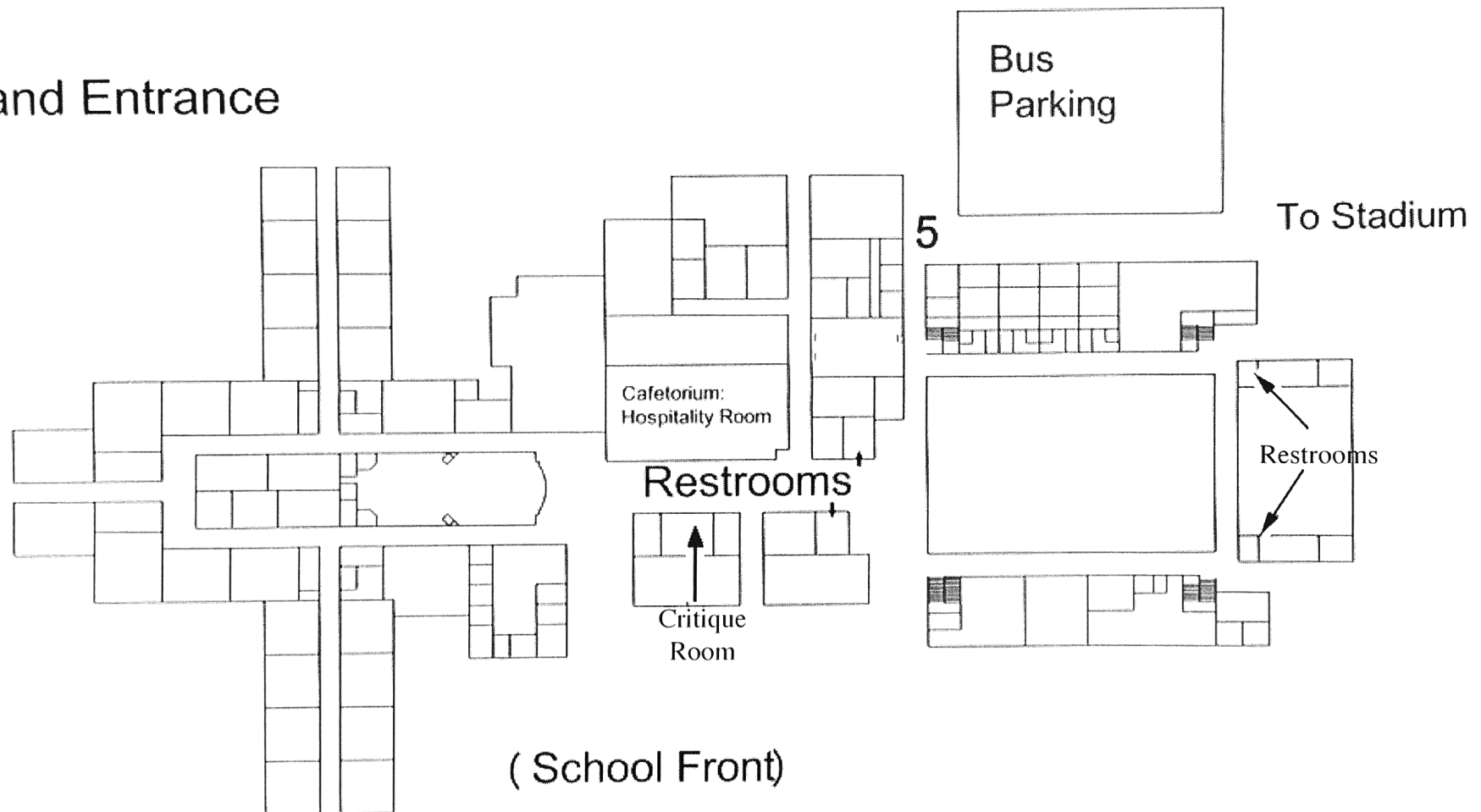

Band Exit

State Road 1 North



Walmart

State Road  
116 West

Highway  
124 East

Wabash  
Street

Market  
Street

Washington  
Street

Wiley  
Avenue

Spring  
Street

Traffic  
Signal

SR 116 East

Kroger

## *On The Banks Of The Wabash Bluffton High School*

### Parking

#### Buses & Equipment at Bluffton High School

Bands enter for parking on the north drive from Wayne Street

Bands exit parking on the south drive to Wayne Street

#### Spectators at Bluffton Middle School

Spectators enter and exit the middle school parking lot on SR116

*New - Additional spectator parking off  
of Spring Street*

Stogdill  
Road

Band Entrance

Wayne  
Street

BHS

Band  
Parking

Park  
Field

BES

Spectator  
Parking

BMS

Band Exit

SR 116 East